

Middle overview Explosionsdarstellung Mittelteil

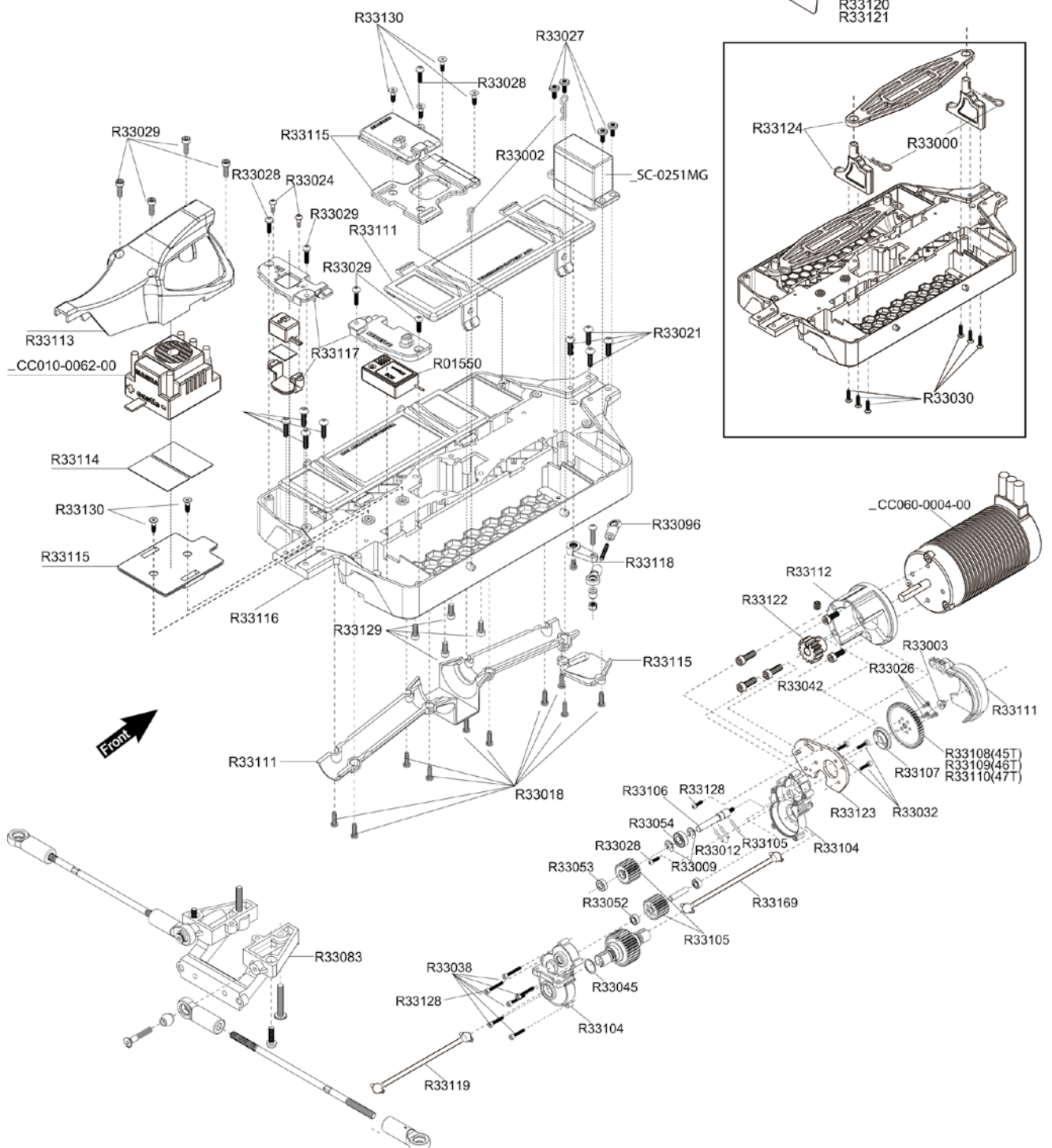

Front overview

Explosionsdarstellung Vorderachse

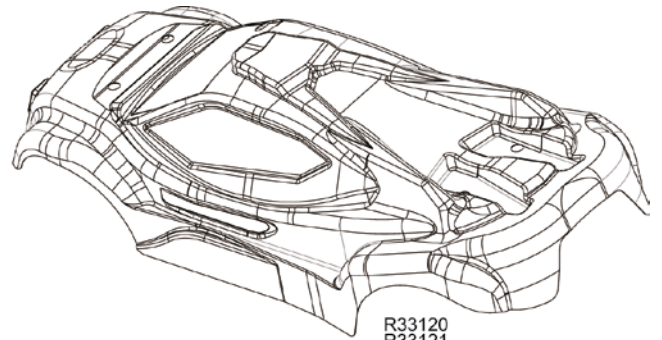
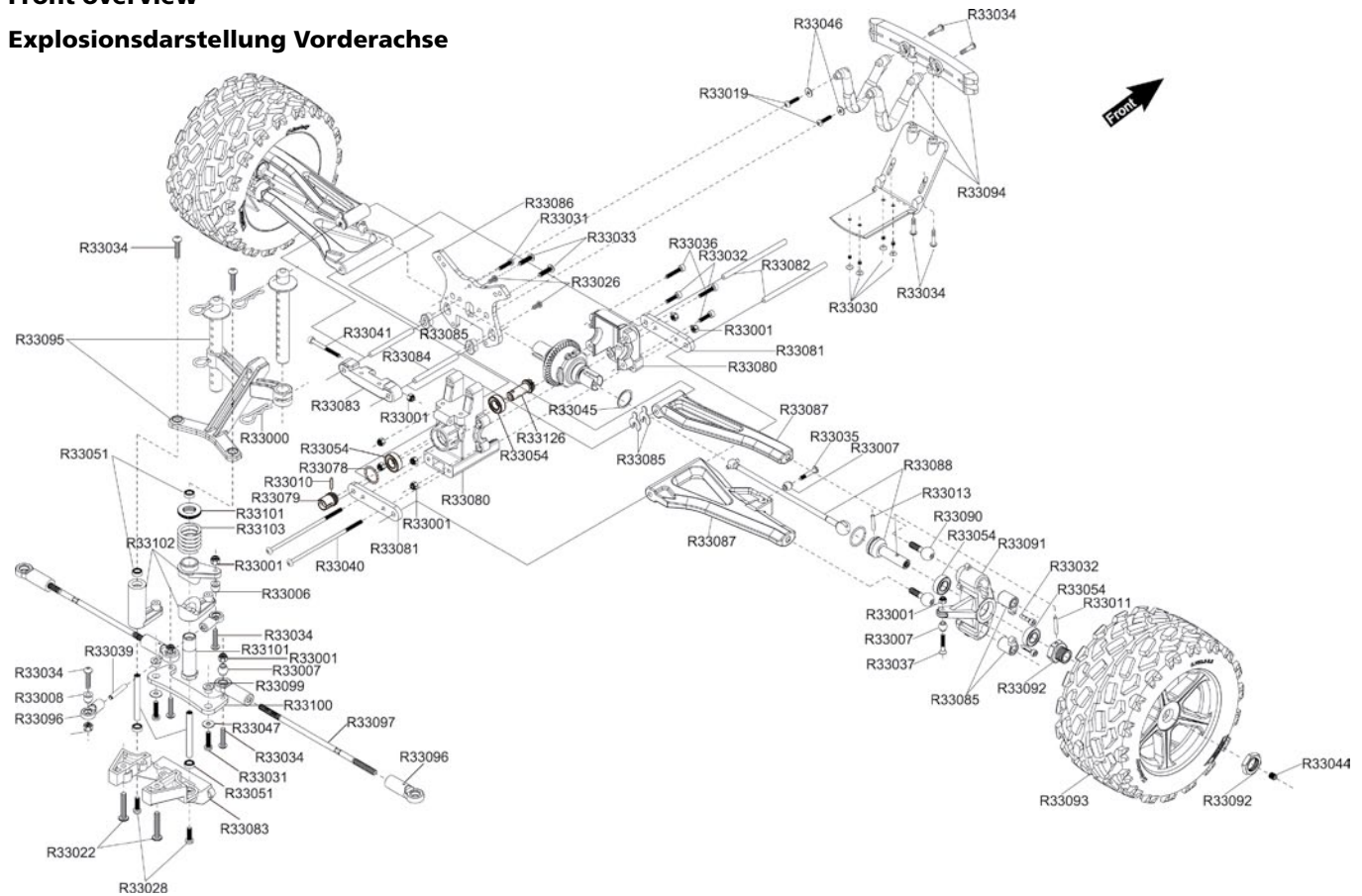

Shock absorber - and Differential gear overview

Explosionsdarstellung Stoßdämpfer und Differentialgetriebe

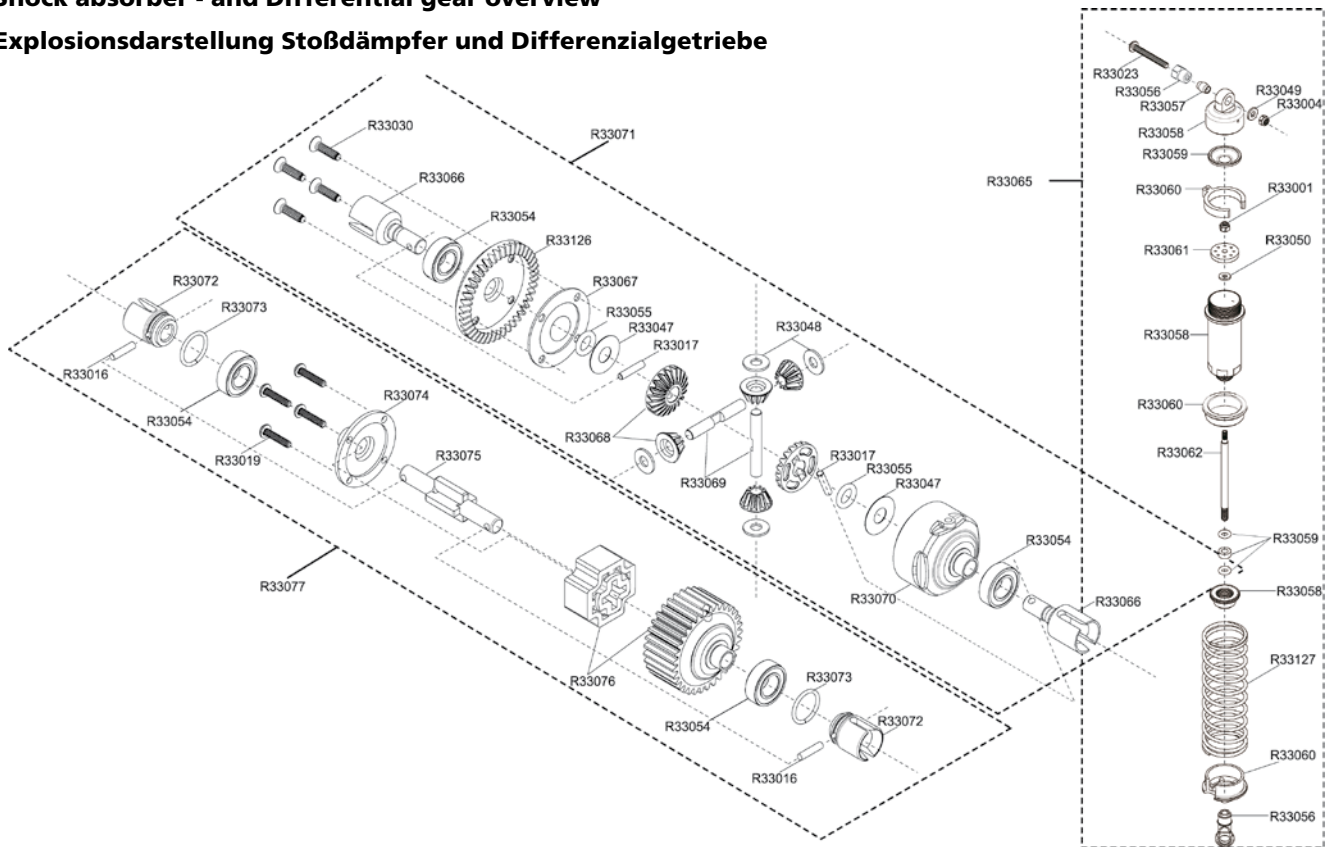

Rear overview

Explosionsdarstellung Hinterachse

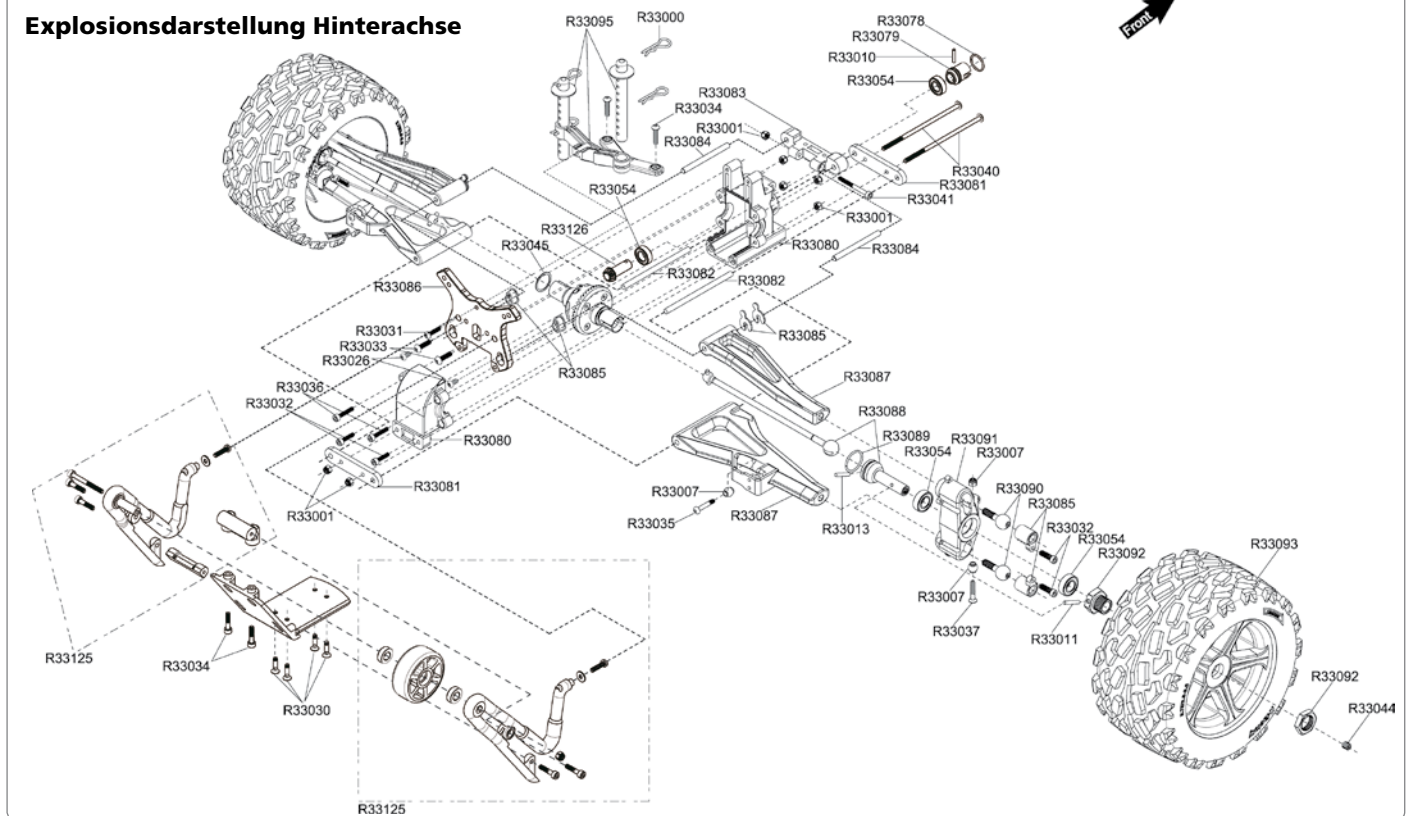

Item No / Art.Nr	Description / Beschreibung
R33000	R8 R-Clip (10) / Splint groß
R33001	3mm Steel Locknut (10) / M3 Stoppmutter (10)
R33002	R5 R-clip (10) / Splint klein
R33003	4mm Lock Nut (10) / M4 Stoppmutter (10)
R33004	3.5mm Lock Nut (10) / M3.5 Stoppmutter (10)
R33005	Steering Servo Saver (Futaba) / Servohorn (Futaba)
R33006	Ball End & 5.8mm Single Flanged Steel Ball (6) Black / Kugelkopf mit Flansch 5.8mm schwarz (6)
R33007	c Ball (10) / Kugelkopf mit Flansch 6.8mm (10)
R33008	5.8mm Single Flanged Steel Ball (6) / Kugelkopf mit Flansch 5.8mm (6)
R33009	E-clip 5 (10) / E-Clip 5 (10)
R33010	2.5x12.8mm Pin (10) / Stift 2.5x12.8mm (10)
R33011	2.5x16.8mm PIN(10) / Stift 2.5x16.8mm (10)
R33012	2x13.8mm Pin (10) / Stift 2x13.8mm (10)
R33013	2.5x14.8mm Pin (10) / Stift 2.5x14.8mm (10)
R33014	5x23.9mm Pin (10) / Stift 5x23.9mm (10)
R33015	2x14.8mm Pin (10) / Stift 2x14.8mm (10)
R33016	2.5x10.8mm Pin (10) / Stift 2.5x10.8mm (10)
R33017	2.5x11.8mm Pin (10) / Stift 2.5x11.8mm (10)
R33018	3x10mm Steel RH TP Screw (cross) (6) / 3x10mm Schneidschraube Linsenkopf (kreuz) (6)
R33019	M2.5X12mm BH Screw(10) / M2.5x12mm Rundkopfschraube (10)
R33020	3.5x10mm Steel Cap Screw (6) / M3.5x10mm Kopfschraube (6)
R33021	3.5x16mm Steel BH Screw (6) / M3.5x16mm Rundkopfschraube (6)
R33022	3.5x20mm Steel BH Screw (6) / M3.5x20mm Rundkopfschraube (6)
R33023	3.5x28mm Steel BH Screw (6) / M3.5x28mm Rundkopfschraube (6)
R33024	2.6x8mm Steel Button Head Screw(6) / M2.6x8mm Rundkopfschraube (6)
R33025	3x3mm Set Screw (6) / M3x3mm Wurmschraube (6)
R33026	3x6mm Steel Button Head Screw (6) / M3x6mm Rundkopfschraube (6)
R33027	3x8mm Steel Flat Round Servo Mount Screw (6) / M3x8mm Servobefestigungsschraube (6)
R33028	3x10mm Button Head Screw (6) / M3x10mm Rundkopfschraube (6)

Item No / Art.Nr	Description / Beschreibung
R33029	3x10mm Cap Screw (6) / M3x10mm Kopfschraube (6)
R33030	3x12mm Steel F.H. Screw (6) / M3x12mm Senkkopfschraube (6)
R33031	3x12mm Button Head Screw (6) / M3x12mm Rundkopfschraube (6)
R33032	3x12mm Steel Cap Screw (6) / M3x12mm Kopfschraube (6)
R33033	3.5x13mm Button Head Screw (6) / M3.5x13mm Rundkopfschraube (6)
R33034	3x14mm Button Head Screw (6) / M3x14mm Rundkopfschraube (6)
R33035	M3X16mm BH Screw(10) / M3x16mm Rundkopfschraube(10)
R33036	3x16mm Cap Screw (6) / M3x16mm Kopfschraube (6)
R33037	3x18mm Steel FH Screw (6) / M3x18mm Senkkopfschraube (6)
R33038	3x20mm Cap Screw (6) / M3x20mm Kopfschraube (6)
R33039	3x20mm Set Screw (6) / M3x20mm Wurmschraube (6)
R33040	3x80mm Steel RH Screw (cross) (6) / M3x80mm Rundkopfschraube (kreuz) (6)
R33041	3x30mm Cap Screw (6) / M3x30mm Kopfschraube (6)
R33042	4x4mm Thread Lock Set Screw (6) / M4x4mm Wurmschraube (Sicherungslock) (6)
R33043	4x10mm Steel Cap Screw(6) / M4x10mm Kopfschraube (6)
R33044	5x5mm Set Screw (6) / M5x5mm Wurmschraube (6)
R33045	13.2x15.9x0.5mm Shim (6) / 13.2x15.9x0.5mm Passscheibe (6)
R33046	3.2x8x0.7 Washer (10) / 3.2x8x0.7mm Beilagscheibe (10)
R33047	6.2x15x0.3 Washer (10) / 6.2x15x0.3mm Beilagscheibe (10)
R33048	4.2x9.6x1mm Washer (10) / 4.2x9.6x1mm Beilagscheibe (10)
R33049	3.6x8x1mm Washer (10) / 3.6x8x1mm Beilagscheibe (10)
R33050	3x7x1mm Washer (10) / 3x7x1mm Beilagscheibe (10)
R33051	4X7X2.5mm Bearing(4) / 4x7x2.5mm Lager (4)
R33052	5x10x4mm Steel Bearing (4) / 5x10x4mm Kugellager (4)
R33053	6x12x4mm Bearing (4) / 6x12x4mm Kugellager (4)
R33054	8x16x5mm Dust-Resistant Bearing (4) / 8x16x5mm Kugellager (abgedichtet) (4)
R33055	O-RING P6(10) / O-Ring P6 (10)
R33056	Shock Pivot Ball Mount (4) / Stoßdämpfer Befestigungsmutter (4)
R33057	Shock Pivot Ball (4) / Kugelkopf Dämpfer (4)

Item No / Art.Nr	Description / Beschreibung
R33058	Shock Body (2) / Stoßdämpferzylinder (2)
R33059	Shock Bladder 17mm (4) / Dämpfermembran 17mm (4)
R33060	Shock Spring Holder / Dämpferfederhalter
R33061	Shock Piston / Dämpferkolben
R33062	Shock Shaft (2) / Kolbenstange (2)
R33063	Shock O-Ring & Washer / Dämpfer O-Ring & Scheibe
R33064	Shock Spring (Red) (2) / Dämpferfeder (rot) (2)
R33065	Shock Absorber Set / Dämpfer Set
R33066	F/R Differential Outdrive (2) / Diffausgänge vo/hi (2)
R33067	Differential Case Gasket (4) / Differentialgehäusedichtung (4)
R33068	Differential Bevel Gear Set (for 1 diff) / Differential Kegelrad (2)
R33069	Differential Bevel Shaft (2) / Differentialwelle (2)
R33070	Bevel Gear Case / Diffgehäuse
R33071	Complete Differential Kit (F/R) / Differential Set für vorne oder hinten
R33072	Center Solid Axle Outdriver (2) / Ausgang Zentralgetriebe (2)
R33073	C-Clip 10.8x1.1mm (4) / C-Clip 10.8x1.1mm (4)
R33074	Center Gear Cover / Zentralgetriebedeckel
R33075	Center Solid Axle / Zentraltriebewelle
R33076	Center Gear (33T) / Zahnrad Zentralgetriebe (33T)
R33077	Complete Center Spool Kit / Zentralgetriebe Set
R33078	C-Clip 13x1.3mm (4) / C-Clip 13x1.3mm (4)
R33079	Joints Outdriver (2) / Diffausgang (2)
R33080	Differential Box / Differentialgehäuse
R33081	Lower Arm Mount (BK) (2) / Querlenkerhalterung unten (2)
R33082	Lower Arm Hinge Pin 4x70mm (2) / Unterer Schwingenstift 4x70mm (2)
R33083	Front/Rear Upper Arm Hinge Pin Mount (4) / Querlenkerhalterung oben vo/hi (4)
R33084	Upper Arm Hinge Pin 4x48mm (2) / Oberer Schwingenstift 4x48mm (2)
R33085	Nylon Adjuster & Pivot Ball Mount / Einstellschraube für Pvo Ball
R33086	Shock Tower (BK) / Dämpferbrücke
R33087	Arm Set / Schwingen Set
R33088	CVA Joints (2) / CVA Antriebswelle (2)
R33089	C-Clip 15x1.3mm (4) / C-Clip 15x1.3mm (4)
R33090	Pivot Ball (11mm) (4) / Pivot Ball (11mm) (4)
R33091	Steering Block (2) / Radträger (2)
R33092	Wheel Adapter Set (BK) (2) / Radnabe (2)
R33093	Mounted Tire (Pair) / Reifen mit Felge verklebt (2)
R33094	Bumper Set / Bumper Set
R33095	Body Post Set (F/R) / Karosseriehalterung (vo/hi)
R33096	Ball Cup 5.8mm (10) / Kugelkopffanne 5.8mm (10)

Item No / Art.Nr	Description / Beschreibung
R33097	4x110mm Rod (2) / 4x110mm Gewindestange re/li (2)
R33098	Servo Saver Inner Post / Servo Saver Steher
R33099	Steering Bushing / Lenkungsbuchse
R33100	Steering Linkage Plate / Lenkungsplatte
R33101	Servo Saver Post / Servo Saver Steher
R33102	Servo Saver Nylon Parts / Servo Saver Kunststoffteile
R33103	Servo Saver Spring / Servo Saver Feder
R33104	Reduction Gear Box / Gehäuse Zentralgetriebe
R33105	Reduction Gears / Zahnräder Zentralgetriebe
R33106	Spur Gear Shaft / Welle Zentralgetriebe
R33107	Spur Gear Hub / Hauptzahnradbefestigung
R33108	Spur Gear-45T / Hauptzahnrad 45T
R33109	Spur Gear-46T / Hauptzahnrad 46T
R33110	Spur Gear-47T / Hauptzahnrad 47T
R33111	Spur Gear, Battery , Driveshafts Cover / Abdeckung Hauptzahnrad, Batterie, Antrieb
R33112	Motor Mount (BK) / Motorträger
R33113	ESC Cover / ESC Abdeckung
R33114	Double Side Tape / Doppelseitiges Klebeband
R33115	ESC&Motor Mount , Front Nylon Cover / ESC & Motorabdeckung
R33116	Chassis / Chassis
R33117	Switch Mount and Rear Nylon Cover / Schalterbefestigung und Empfängerabdeckung
R33118	Alum. Servo Arm (Futaba) / Aluminium Servoarm (Futaba)
R33119	Center Universal Joint / Mittelantriebswelle
R33120	Body Shell (Painted) / Karosserie (lackiert)
R33121	Body Shell (Clear) / Karosserie (unlackiert)
R33122	Pinion Gear-14T (M1) / Ritzel 14T (M1)
R33123	Spur Gear Linkage Plate (BK) / Getriebezwischenbefestigung
R33124	Quick- Release Battery Holder / Schnellwechsel Batteriehalter
R33125	The Fifth Wheel Set / Wheelie bar
R33126	Machined Bevel Gear -43T/11T / Kegelrad gefräst 43T/11T
R33127	Shock Spring (White) (2) / Dämpferfeder (weiß) (2)
R33129	3.5x8mm Steel Cap Screw (6) / M3.5x8mm Kopfschraube (6)
R33130	3x10mm Steel F.H. Screw (6) / M3x10mm Flachkopfschraube (6)
_CC010-0062-00	Mamba Monster 1:8 ESC 25V Extreme
_CC060-0004-00	Mamba BL-Motor 2200Kv
_SC-0251MG	Savöx Digital Servo SC-0251MG (0,18 sec./16kg)
R01502	2,4GHz TL-3C 3-Chanel LCD Radio Set /Fernsteuerung
R01550	2,4GHz XY3000 3-Chanel Receiver / Empfänger



Robitronic Electronic Ges.m.b.H

Brunhildengasse 1/1 | A -1150 Wien | Österreich

Tel.: +43 1-982 09 20 | Fax: +43 1-982 09 21

www.robitoronic.com

Technische Änderungen sowie Änderungen in Ausstattung und Design vorbehalten.

Technical changes and changes in equipment and design reserved.

